

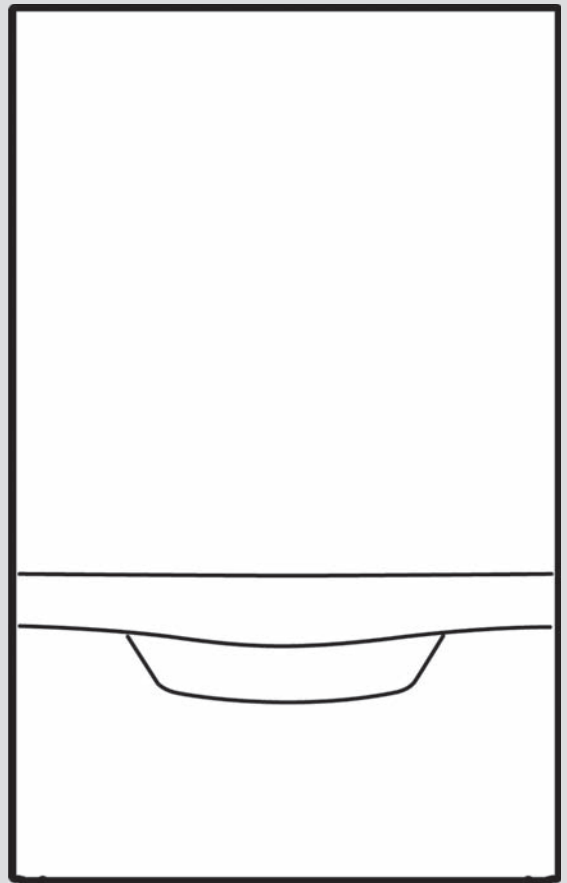

ecoTEC plus

VU, VUW ..6/5-5



3 Technical data

Technical data – General

	VU 126/5-5 (H-GB) ecoTEC plus 612	VU 156/5-5 (H-GB) ecoTEC plus 615	VU 186/5-5 (H-GB) ecoTEC plus 618	VU 186/5-5 (P-GB) ecoTEC plus 618	VU 246/5-5 (H-GB) ecoTEC plus 624	VU 306/5-5 (H-GB) ecoTEC plus 630
Designated country (designation in accordance with ISO 3166)	GB (Great Britain), IE (Ireland)	GB (Great Britain), IE (Ireland)	GB (Great Britain), IE (Ireland)	GB (Great Britain), IE (Ireland)	GB (Great Britain), IE (Ireland)	GB (Great Britain), IE (Ireland)
Approved gas boiler categories	I _{2H}	I _{2H}	II _{2H3P}	II _{2H3P}	II _{2H3P}	II _{2H3P}
Gas connection, boiler side	15 mm	15 mm	15 mm	15 mm	15 mm	15 mm
Flow/return heating connections, boiler side	22 mm	22 mm	22 mm	22 mm	22 mm	22 mm
Domestic hot and cold water connection, boiler side	–	–	–	–	–	–
Expansion relief valve connection pipe (min.)	15 mm	15 mm	15 mm	15 mm	15 mm	15 mm
Air/flue gas connection	60/100 mm	60/100 mm	60/100 mm	60/100 mm	60/100 mm	60/100 mm
Condensate drain pipe-work (min.)	19 mm	19 mm	19 mm	19 mm	19 mm	19 mm
G20 natural gas flow pressure	2.0 kPa (20.0 mbar)	2.0 kPa (20.0 mbar)	2.0 kPa (20.0 mbar)	–	2.0 kPa (20.0 mbar)	2.0 kPa (20.0 mbar)
G31 propane gas flow pressure	–	–	–	3.7 kPa (37.0 mbar)	–	–
Gas flow rate at 15 °C and 1013 mbar (based on domestic hot water generation, if applicable), G20	1.3 m ³ /h	1.7 m ³ /h	2.0 m ³ /h	–	2.6 m ³ /h	3.7 m ³ /h
Gas flow rate at 15 °C and 1013 mbar (based on domestic hot water generation, if applicable), G31	–	–	–	1.5 kg/h	–	–
Min. flue gas mass flow rate (G20)	1.44 g/s	1.44 g/s	1.80 g/s	–	2.47 g/s	2.78 g/s
Min. flue gas mass flow rate (G31)	–	–	–	2.40 g/s	–	–
Max. flue gas mass flow rate	5.6 g/s	7.0 g/s	8.4 g/s	8.4 g/s	11.1 g/s	13.9 g/s
Min. flue gas temperature	40 °C	40 °C	40 °C	40 °C	40 °C	40 °C
Max. flue gas temperature	70 °C	70 °C	70 °C	70 °C	70 °C	70 °C
Approved gas boiler types	C13, C33, C43, C53	C13, C33, C43, C53	C13, C33, C43, C53	C13, C33, C43, C53	C13, C33, C43, C53	C13, C33, C43, C53
30% efficiency	109.3 %	109.3 %	109.6 %	108.5 %	109.5 %	109.4 %
NOx class	6	6	6	6	6	6
Test symbol/registration no.	CE-0085CM0320	CE-0085CM0320	CE-0085CM0320	CE-0085CM0320	CE-0085CM0320	CE-0085CM0320
SAP 2009/2012 annual efficiency (%)	89.3 %	89.2 %	89.6 %	89.6 %	89.6 %	89.5 %
Boiler dimension, width	440 mm	440 mm	440 mm	440 mm	440 mm	440 mm
Boiler dimension, height	720 mm	720 mm	720 mm	720 mm	720 mm	720 mm
Boiler dimension, depth	338 mm	338 mm	338 mm	338 mm	338 mm	372 mm
Mounting weight	36 kg	36 kg	36 kg	36 kg	37 kg	38 kg

	VU 306/5-5 (P-GB) ecoTEC plus 630	VU 386/5-5 (H-GB) ecoTEC plus 637	VUW 196/5-5 (H-GB) ecoTEC plus 825	VUW 246/5-5 (H-GB) ecoTEC plus 832	VUW 246/5-5 (P-GB) ecoTEC plus 832	VUW 306/5-5 (H-GB) ecoTEC plus 835
Designated country (designation in accordance with ISO 3166)	GB (Great Britain), IE (Ireland)	GB (Great Britain), IE (Ireland)	GB (Great Britain), IE (Ireland)	GB (Great Britain), IE (Ireland)	GB (Great Britain), IE (Ireland)	GB (Great Britain), IE (Ireland)
Approved gas boiler categories	II _{2H3P}	II _{2H3P}	II _{2H3P}	II _{2H3P}	II _{2H3P}	II _{2H3P}
Gas connection, boiler side	15 mm	15 mm	15 mm	15 mm	15 mm	15 mm
Flow/return heating connections, boiler side	22 mm	22 mm	22 mm	22 mm	22 mm	22 mm
Domestic hot and cold water connection, boiler side	–	–	G 3/4"	G 3/4"	G 3/4"	G 3/4"
Expansion relief valve connection pipe (min.)	15 mm	15 mm	15 mm	15 mm	15 mm	15 mm
Air/flue gas connection	60/100 mm	60/100 mm	60/100 mm	60/100 mm	60/100 mm	60/100 mm
Condensate drain pipe-work (min.)	19 mm	19 mm	19 mm	19 mm	19 mm	19 mm
G20 natural gas flow pressure	–	2.0 kPa (20.0 mbar)	2.0 kPa (20.0 mbar)	2.0 kPa (20.0 mbar)	–	2.0 kPa (20.0 mbar)
G31 propane gas flow pressure	3.7 kPa (37.0 mbar)	–	–	–	3.7 kPa (37.0 mbar)	–
Gas flow rate at 15 °C and 1013 mbar (based on domestic hot water generation, if applicable), G20	–	4.1 m ³ /h	2.7 m ³ /h	3.4 m ³ /h	–	3.8 m ³ /h
Gas flow rate at 15 °C and 1013 mbar (based on domestic hot water generation, if applicable), G31	2.4 kg/h	–	–	–	2.5 kg/h	–
Min. flue gas mass flow rate (G20)	–	3.05 g/s	1.80 g/s	2.47 g/s	–	2.78 g/s
Min. flue gas mass flow rate (G31)	4.08 g/s	–	–	–	2.90 g/s	–
Max. flue gas mass flow rate	13.9 g/s	17.4 g/s	8.4 g/s	11.1 g/s	11.1 g/s	16.2 g/s
Min. flue gas temperature	40 °C	40 °C	40 °C	40 °C	40 °C	40 °C
Max. flue gas temperature	70 °C	70 °C	70 °C	70 °C	70 °C	70 °C
Approved gas boiler types	C13, C33, C43, C53	C13, C33, C43, C53	C13, C33, C43, C53	C13, C33, C43, C53	C13, C33, C43, C53	C13, C33, C43, C53
30% efficiency	108 %	109.3 %	109.6 %	109.5 %	108 %	109.4 %
NOx class	6	6	6	6	6	6
Test symbol/registration no.	CE-0085CM0320	CE-0085CM0320	CE-0085CM0320	CE-0085CM0320	CE-0085CM0320	CE-0085CM0320
SAP 2009/2012 annual efficiency (%)	89.7 %	89.5 %	89.5 %	89.5 %	89.5 %	89.4 %
Boiler dimension, width	440 mm	440 mm	440 mm	440 mm	440 mm	440 mm
Boiler dimension, height	720 mm	720 mm	720 mm	720 mm	720 mm	720 mm
Boiler dimension, depth	372 mm	406 mm	338 mm	338 mm	338 mm	372 mm
Mounting weight	38 kg	43 kg	36 kg	37 kg	37 kg	41 kg

	VUW 286/5-5 (H-GB) ecoTEC plus 838
Designated country (designation in accordance with ISO 3166)	GB (Great Britain), IE (Ireland)
Approved gas boiler categories	II _{2H3P}
Gas connection, boiler side	15 mm
Flow/return heating connections, boiler side	22 mm
Domestic hot and cold water connection, boiler side	G 3/4"
Expansion relief valve connection pipe (min.)	15 mm
Air/flue gas connection	60/100 mm
Condensate drain pipe-work (min.)	19 mm
G20 natural gas flow pressure	2.0 kPa (20.0 mbar)
G31 propane gas flow pressure	–
Gas flow rate at 15 °C and 1013 mbar (based on domestic hot water generation, if applicable), G20	4.2 m ³ /h
Gas flow rate at 15 °C and 1013 mbar (based on domestic hot water generation, if applicable), G31	–
Min. flue gas mass flow rate (G20)	3.05 g/s
Min. flue gas mass flow rate (G31)	–
Max. flue gas mass flow rate	17.9 g/s
Min. flue gas temperature	40 °C
Max. flue gas temperature	70 °C
Approved gas boiler types	C13, C33, C43, C53
30% efficiency	109.4 %
NOx class	6
Test symbol/registration no.	CE-0085CM0320
SAP 2009/2012 annual efficiency (%)	89.4 %
Boiler dimension, width	440 mm
Boiler dimension, height	720 mm
Boiler dimension, depth	406 mm
Mounting weight	44 kg

Technical data – G20 power/loading G20

	VU 126/5-5 (H-GB) ecoTEC plus 612	VU 156/5-5 (H-GB) ecoTEC plus 615	VU 186/5-5 (H-GB) ecoTEC plus 618	VU 246/5-5 (H-GB) ecoTEC plus 624	VU 306/5-5 (H-GB) ecoTEC plus 630	VU 386/5-5 (H-GB) ecoTEC plus 637
Nominal heat output range P at 50/30 °C	3.3 to 13.2 kW	3.3 to 16.7 kW	4.1 to 20.0 kW	5.7 to 26.4 kW	6.4 to 32.8 kW	7.1 to 40.5 kW
Nominal heat output range P at 80/60 °C	3.0 to 12.2 kW	3.0 to 15.2 kW	3.8 to 18.2 kW	5.2 to 24.4 kW	5.8 to 30.4 kW	6.4 to 37.6 kW
Maximum heat output for domestic hot water generation	12.2 kW	15.2 kW	18.2 kW	24.4 kW	30.4 kW	37.6 kW
Maximum heat input for domestic hot water generation	12.4 kW	15.5 kW	18.9 kW	24.7 kW	30.9 kW	38.1 kW
Maximum heat input, heating side	12.4 kW	15.5 kW	18.6 kW	24.7 kW	30.9 kW	38.1 kW
Minimum heat input	3.2 kW	3.2 kW	4.0 kW	5.5 kW	6.2 kW	6.8 kW
Heating adjustment range	3 to 12 kW	3 to 15 kW	4 to 19 kW	5 to 24 kW	6 to 30 kW	6 to 38 kW
Nominal heat input efficiency (stationary) at 40/30 °C	108.0 %	109.0 %	109.0 %	108.0 %	107.0 %	107.0 %
Nominal heat input efficiency (stationary) at 50/30 °C	106.0 %	108.0 %	108.0 %	107.0 %	106.0 %	106.0 %
Nominal heat input efficiency (stationary) at 60/40 °C	101.0 %	101.0 %	101.0 %	101.0 %	101.0 %	101.0 %
Nominal heat input efficiency (stationary) at 80/60 °C	99 %	98.0 %	98.0 %	98.0 %	98.0 %	98.0 %

	VUW 196/5-5 (H-GB) ecoTEC plus 825	VUW 246/5-5 (H-GB) ecoTEC plus 832	VUW 306/5-5 (H-GB) ecoTEC plus 835	VUW 286/5-5 (H-GB) ecoTEC plus 838
Nominal heat output range P at 50/30 °C	4.1 to 20.8 kW	5.7 to 26.4 kW	6.4 to 32.8 kW	7.1 to 30.9 kW
Nominal heat output range P at 80/60 °C	3.8 to 19.3 kW	5.2 to 24.4 kW	5.8 to 30.4 kW	6.5 to 28.6 kW
Maximum heat output for domestic hot water generation	24.4 kW	31.8 kW	34.0 kW	38.7 kW
Maximum heat input for domestic hot water generation	24.7 kW	32.2 kW	34.7 kW	39.2 kW
Maximum heat input, heating side	19.6 kW	24.7 kW	30.9 kW	28.9 kW
Minimum heat input	4.0 kW	5.5 kW	6.2 kW	6.8 kW
Heating adjustment range	4 to 19 kW	5 to 24 kW	6 to 30 kW	6 to 29 kW
Nominal heat input efficiency (stationary) at 40/30 °C	108.0 %	108.0 %	107.0 %	107.0 %
Nominal heat input efficiency (stationary) at 50/30 °C	106.0 %	107.0 %	106.0 %	107.0 %
Nominal heat input efficiency (stationary) at 60/40 °C	101.0 %	101.0 %	101.0 %	101.0 %
Nominal heat input efficiency (stationary) at 80/60 °C	98.0 %	98.0 %	98.0 %	98.0 %

Technical data – Power/loading G31

	VU 186/5-5 (P-GB) ecoTEC plus 618	VU 306/5-5 (P-GB) ecoTEC plus 630	VUW 246/5-5 (P-GB) ecoTEC plus 832
Nominal heat output range P at 50/30 °C	5.4 to 19.4 kW	9.4 to 31.9 kW	6.5 to 25.5 kW
Nominal heat output range P at 80/60 °C	5.0 to 18.2 kW	8.5 to 30.4 kW	6.0 to 24.4 kW
Maximum heat output for domestic hot water generation	18.3 kW	30.4 kW	31.8 kW
Maximum heat input for domestic hot water generation	18.6 kW	30.9 kW	32.2 kW
Maximum heat input, heating side	18.6 kW	30.9 kW	24.7 kW
Minimum heat input	5.3 kW	9.0 kW	6.4 kW
Nominal heat input efficiency (stationary) at 40/30 °C	104.0 %	104.0 %	104.0 %
Nominal heat input efficiency (stationary) at 50/30 °C	104.0 %	103.0 %	103.0 %
Nominal heat input efficiency (stationary) at 60/40 °C	101.0 %	101.0 %	101.0 %
Nominal heat input efficiency (stationary) at 80/60 °C	98.0 %	98.0 %	98.0 %

Technical data – Heating

	VU 126/5-5 (H-GB) ecoTEC plus 612	VU 156/5-5 (H-GB) ecoTEC plus 615	VU 186/5-5 (H-GB) ecoTEC plus 618	VU 186/5-5 (P-GB) ecoTEC plus 618	VU 246/5-5 (H-GB) ecoTEC plus 624	VU 306/5-5 (H-GB) ecoTEC plus 630
Maximum flow temperature	85 °C	85 °C	85 °C	85 °C	85 °C	85 °C
Max. flow temperature adjustment range (default setting: 75 °C)	30 to 80 °C	30 to 80 °C	30 to 80 °C	30 to 80 °C	30 to 80 °C	30 to 80 °C
Permissible operating pressure	0.25 MPa (2.50 bar)	0.25 MPa (2.50 bar)	0.25 MPa (2.50 bar)	0.25 MPa (2.50 bar)	0.25 MPa (2.50 bar)	0.25 MPa (2.50 bar)
Minimum pressure for full operation	0.08 MPa (0.80 bar)	0.08 MPa (0.80 bar)	0.08 MPa (0.80 bar)	0.08 MPa (0.80 bar)	0.08 MPa (0.80 bar)	0.08 MPa (0.80 bar)
Expansion vessel capacity	10 l	10 l	10 l	10 l	10 l	10 l
Circulation water volume (with reference to $\Delta T = 20$ K)	525 l/h	662 l/h	796 l/h	796 l/h	1,049 l/h	1,307 l/h
Approx. condensate rate (pH value 3.5 to 4.0) in 50/30 °C heating mode	1.2 l/h	1.6 l/h	1.9 l/h	1.9 l/h	2.5 l/h	3.1 l/h
Remaining feed head of pump (at nominal circulation water volume)	0.025 MPa (0.250 bar)	0.025 MPa (0.250 bar)	0.025 MPa (0.250 bar)	0.025 MPa (0.250 bar)	0.025 MPa (0.250 bar)	0.025 MPa (0.250 bar)

	VU 306/5-5 (P-GB) ecoTEC plus 630	VU 386/5-5 (H-GB) ecoTEC plus 637	VUW 196/5-5 (H-GB) ecoTEC plus 825	VUW 246/5-5 (H-GB) ecoTEC plus 832	VUW 246/5-5 (P-GB) ecoTEC plus 832	VUW 306/5-5 (H-GB) ecoTEC plus 835
Maximum flow temperature	85 °C	85 °C	85 °C	85 °C	85 °C	85 °C
Max. flow temperature adjustment range (default setting: 75 °C)	30 to 80 °C	30 to 80 °C	30 to 80 °C	30 to 80 °C	30 to 80 °C	30 to 80 °C

	VU 306/5-5 (P-GB) ecoTEC plus 630	VU 386/5-5 (H-GB) ecoTEC plus 637	VUW 196/5-5 (H-GB) ecoTEC plus 825	VUW 246/5-5 (H-GB) ecoTEC plus 832	VUW 246/5-5 (P-GB) ecoTEC plus 832	VUW 306/5-5 (H-GB) ecoTEC plus 835
Permissible operating pressure	0.25 MPa (2.50 bar)	0.25 MPa (2.50 bar)	0.25 MPa (2.50 bar)	0.25 MPa (2.50 bar)	0.25 MPa (2.50 bar)	0.25 MPa (2.50 bar)
Minimum pressure for full operation	0.08 MPa (0.80 bar)	0.08 MPa (0.80 bar)	0.08 MPa (0.80 bar)	0.08 MPa (0.80 bar)	0.08 MPa (0.80 bar)	0.08 MPa (0.80 bar)
Expansion vessel capacity	10 l	10 l	10 l	10 l	10 l	10 l
Circulation water volume (with reference to $\Delta T = 20$ K)	1,307 l/h	1,617 l/h	830 l/h	1,049 l/h	1,049 l/h	1,307 l/h
Approx. condensate rate (pH value 3.5 to 4.0) in 50/30 °C heating mode	3.1 l/h	3.8 l/h	2.0 l/h	2.5 l/h	2.5 l/h	3.1 l/h
Remaining feed head of pump (at nominal circulation water volume)	0.025 MPa (0.250 bar)	0.025 MPa (0.250 bar)	0.025 MPa (0.250 bar)	0.025 MPa (0.250 bar)	0.025 MPa (0.250 bar)	0.025 MPa (0.250 bar)

	VUW 286/5-5 (H-GB) ecoTEC plus 838
Maximum flow temperature	85 °C
Max. flow temperature adjustment range (default setting: 75 °C)	30 to 80 °C
Permissible operating pressure	0.25 MPa (2.50 bar)
Minimum pressure for full operation	0.08 MPa (0.80 bar)
Expansion vessel capacity	10 l
Circulation water volume (with reference to $\Delta T = 20$ K)	1,230 l/h
Approx. condensate rate (pH value 3.5 to 4.0) in 50/30 °C heating mode	2.9 l/h
Remaining feed head of pump (at nominal circulation water volume)	0.025 MPa (0.250 bar)

Technical data – Hot water handling mode



	VUW 196/5-5 (H-GB) ecoTEC plus 825	VUW 246/5-5 (H-GB) ecoTEC plus 832	VUW 246/5-5 (P-GB) ecoTEC plus 832	VUW 306/5-5 (H-GB) ecoTEC plus 835	VUW 286/5-5 (H-GB) ecoTEC plus 838
Lowest water volume	2.0 l/min	2.0 l/min	2.0 l/min	2.0 l/min	2.0 l/min
Water volume (at $\Delta T = 30$ K)	12.3 l/min	15.2 l/min	15.2 l/min	16.7 l/min	18.5 l/min
Water volume (at $\Delta T = 35$ K)	10.5 l/min	13.0 l/min	13.0 l/min	14.3 l/min	15.9 l/min
Water volume (at $\Delta T = 42$ K)	8.8 l/min	10.9 l/min	10.9 l/min	11.9 l/min	13.2 l/min
Permitted overpressure	1.0 MPa (10.0 bar)	1.0 MPa (10.0 bar)	1.0 MPa (10.0 bar)	1.0 MPa (10.0 bar)	1.0 MPa (10.0 bar)
Required connection pressure	0.035 MPa (0.350 bar)	0.035 MPa (0.350 bar)	0.035 MPa (0.350 bar)	0.035 MPa (0.350 bar)	0.035 MPa (0.350 bar)
Hot water output temperature range	35 to 65 °C	35 to 65 °C	35 to 65 °C	35 to 65 °C	35 to 65 °C

Technical data – Electrics

	VU 126/5-5 (H-GB) ecoTEC plus 612	VU 156/5-5 (H-GB) ecoTEC plus 615	VU 186/5-5 (H-GB) ecoTEC plus 618	VU 186/5-5 (P-GB) ecoTEC plus 618	VU 246/5-5 (H-GB) ecoTEC plus 624	VU 306/5-5 (H-GB) ecoTEC plus 630
Electric connection	230 V/50 Hz	230 V/50 Hz	230 V/50 Hz	230 V/50 Hz	230 V/50 Hz	230 V/50 Hz
Permissible connected voltage	190 to 253 V	190 to 253 V	190 to 253 V	190 to 253 V	190 to 253 V	190 to 253 V
Built-in fuse (slow-blow)	2 A	2 A	2 A	2 A	2 A	2 A
Min. electrical power consumption	35 W	35 W	35 W	35 W	35 W	45 W
Max. electrical power consumption	55 W	60 W	65 W	65 W	70 W	90 W
Electrical power consumption, standby	< 2 W	< 2 W	< 2 W	< 2 W	< 2 W	< 2 W
Level of protection	IP X4 D	IP X4 D	IP X4 D	IP X4 D	IP X4 D	IP X4 D

	VU 306/5-5 (P-GB) ecoTEC plus 630	VU 386/5-5 (H-GB) ecoTEC plus 637	VUW 196/5-5 (H-GB) ecoTEC plus 825	VUW 246/5-5 (H-GB) ecoTEC plus 832	VUW 246/5-5 (P-GB) ecoTEC plus 832	VUW 306/5-5 (H-GB) ecoTEC plus 835
Electric connection	230 V/50 Hz	230 V/50 Hz	230 V/50 Hz	230 V/50 Hz	230 V/50 Hz	230 V/50 Hz
Permissible connected voltage	190 to 253 V	190 to 253 V	190 to 253 V	190 to 253 V	190 to 253 V	190 to 253 V
Built-in fuse (slow-blow)	2 A	2 A	2 A	2 A	2 A	2 A
Min. electrical power consumption	45 W	55 W	35 W	35 W	35 W	45 W
Max. electrical power consumption	80 W	95 W	80 W	85 W	85 W	90 W
Electrical power consumption, standby	< 2 W	< 3 W	< 2 W	< 2 W	< 2 W	< 2 W
Level of protection	IP X4 D	IP X4 D	IP X4 D	IP X4 D	IP X4 D	IP X4 D

	VUW 286/5-5 (H-GB) ecoTEC plus 838
Electric connection	230 V/50 Hz
Permissible connected voltage	190 to 253 V
Built-in fuse (slow-blow)	2 A
Min. electrical power consumption	55 W
Max. electrical power consumption	120 W
Electrical power consumption, standby	< 3 W
Level of protection	IP X4 D

Information on the data plate	Meaning
IP	IP rating
	Heating mode
	Domestic hot water generation
P	Nominal heat output range
Q	Heat input range
D	Nominal domestic hot water draw-off rate
	Barcode with serial number, 7th to 16th digit = product article number



Note

Make absolutely sure that the product is compatible with the gas group at the installation site.

5.5 Serial number

The serial number can be found on a plastic label behind the front flap and on the identification plate.



Note

The serial number can also be shown on the display of the product (→ Operating instructions).

5.6 Product design

5.6.1 Functional elements, product for heating mode only

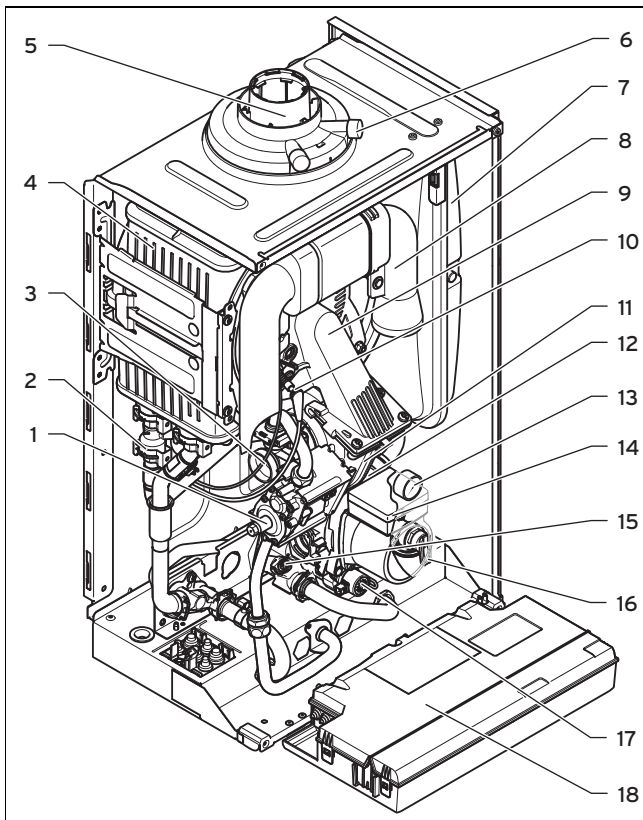

- | | |
|---------------------------------|------------------------------------|
| 1 Gas valve assembly | 5 Connection for the air/flue pipe |
| 2 Water pressure sensor | 6 Flue gas test point |
| 3 Venturi with mass flow sensor | 7 Expansion vessel |
| 4 Heat exchanger | 8 Air intake pipe |

- | | |
|--------------------------|--------------------------------|
| 9 Compact thermal module | 14 Internal pump |
| 10 Ignition electrode | 15 Bypass valve |
| 11 Fan | 16 Expansion relief valve |
| 12 Automatic air vent | 17 Prioritising diverter valve |
| 13 Manometer | 18 Electronics box |

5.6.2 Functional elements, product with domestic hot water generation

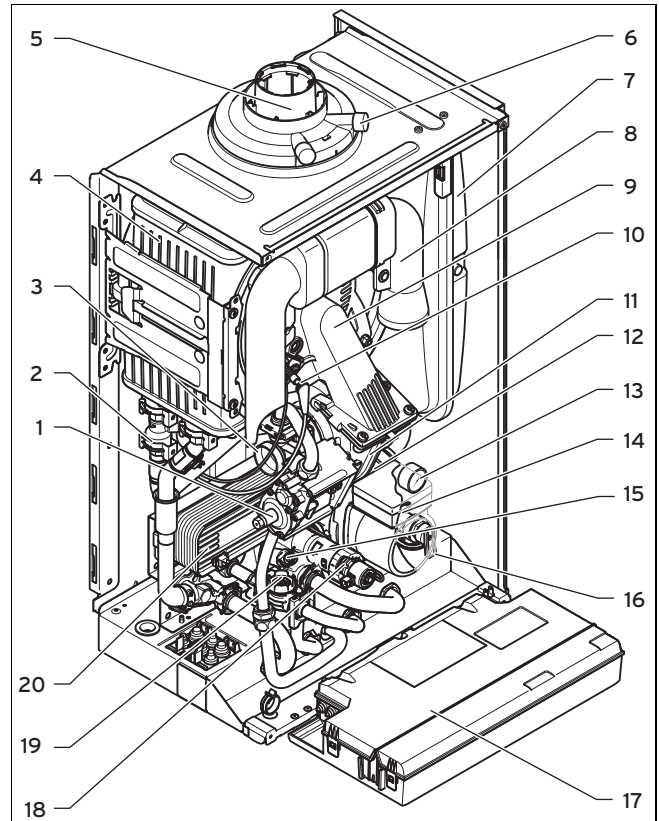

- | | |
|------------------------------------|---|
| 1 Gas valve assembly | 11 Fan |
| 2 Water pressure sensor | 12 Automatic air vent |
| 3 Venturi with mass flow sensor | 13 Manometer |
| 4 Heat exchanger | 14 Internal pump |
| 5 Connection for the air/flue pipe | 15 Bypass valve |
| 6 Flue gas test point | 16 Expansion relief valve |
| 7 Expansion vessel | 17 Electronics box |
| 8 Air intake pipe | 18 Prioritising diverter valve |
| 9 Compact thermal module | 19 Impeller sensor (domestic hot water) |
| 10 Ignition electrode | 20 Secondary heat exchanger |