

INSTALLER

USER

MAINTENANCE TECHNICIAN

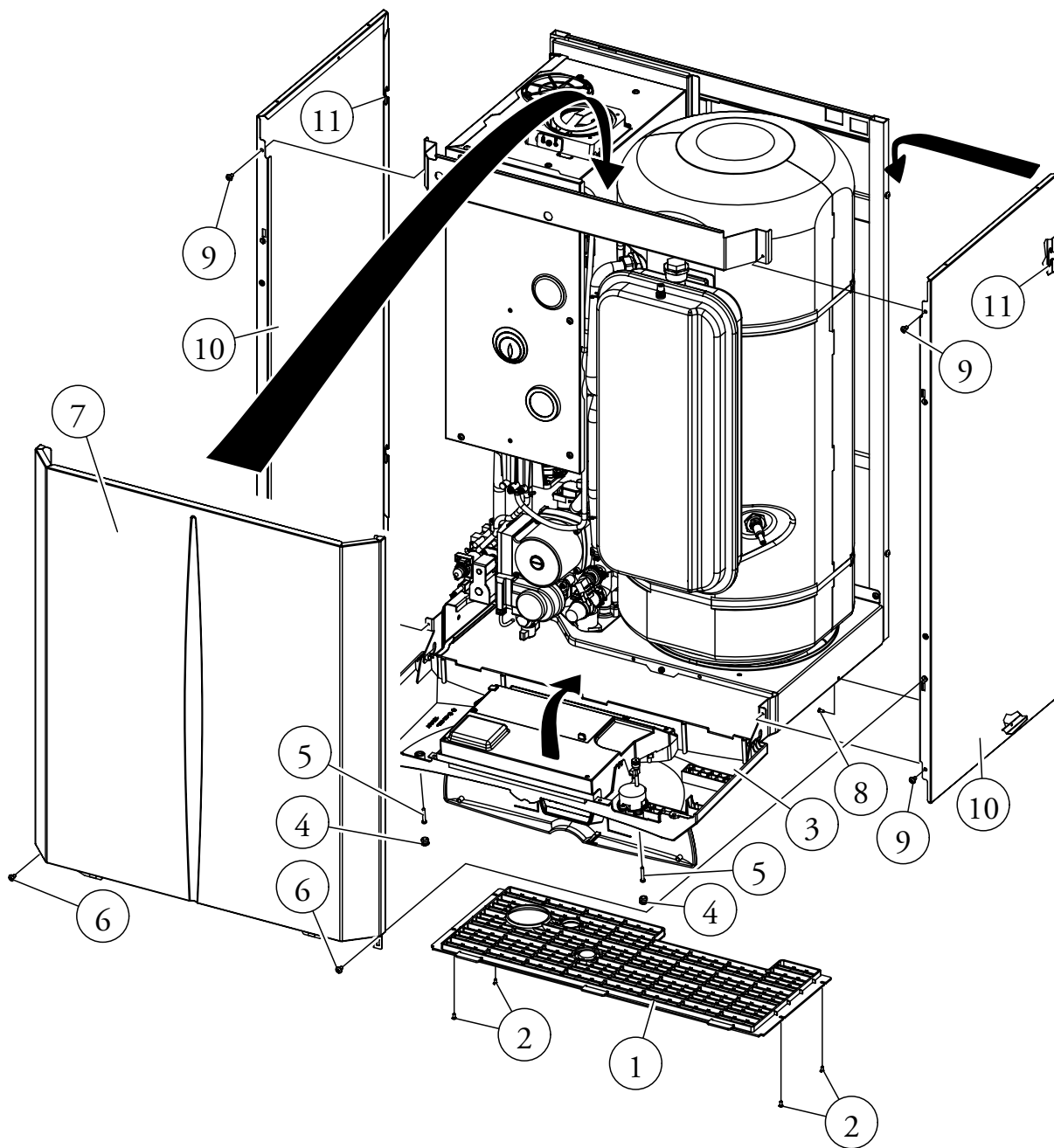

3.18 TECHNICAL DATA.

		Zeus Superior 24 kW	Zeus Superior 28 kW	Zeus Superior 32 kW
Nominal heat input	kW (kcal/h)	25,6 (22028)	29,8 (25644)	33,6 (28910)
Minimum heat input	kW (kcal/h)	10,6 (9120)	13,3 (11402)	14,2 (12188)
Nominal (useful) heat output	kW (kcal/h)	24,0 (20640)	28,0 (24080)	31,7 (27262)
Minimum (useful) heat output	kW (kcal/h)	9,3 (7998)	11,8 (10148)	12,5 (10750)
Efficiency at nominal heat output	%	93,7	93,9	94,3
Efficiency at 30% nominal heat output	%	90,3	91,2	90,8
Casing losses with burner On/Off	%	0,40 / 0,61	0,60 / 0,62	0,40 / 0,60
Chimney losses with burner On/Off	%	5,90 / 0,05	5,50 / 0,01	5,80 / 0,01
Maximum working pressure of C.H. circuit	bar	3	3	3
Maximum working temperature of C.H. circuit	°C	90	90	90
Central heating temperature range	°C	35 - 85	35 - 85	35 - 85
Total volume of system expansion vessel	l	7,1	7,1	7,1
Expansion vessel factory-set pressure	bar	1	1	1
Total volume of DHW expansion vessel	l	1,2	1,2	1,2
DHW expansion vessel factory-set pressure	bar	3,5	3,5	3,5
Appliance water content	l	3,5	4,0	4,5
Available head at 1000 litres/hours flow rate	kPa (m H ₂ O)	32,9 (3,36)	37,26 (3,8)	39,22 (4,0)
Hot water production useful heat output	kW (kcal/h)	24,0 (20640)	28,0 (24080)	31,7 (27262)
DHW temperature adjustable range	°C	20 - 60	20 - 60	20 - 60
2-bar DHW flow limiter	l/min	10,0	12,0	14,0
DHW circuit minimum (dynamic) pressure	bar	0,3	0,3	0,3
Maximum working pressure of DHW circuit	bar	8	8	8
*Specific capacity "D" according to EN 625	l/min	15,3	16,6	18,9
Continuous service capacity (ΔT 30°C)	l/min	11,3	13,7	15,3
Domestic water performance classification according to EN13203-1		★★★		
Loaded boiler weight	kg	126,93	128,64	131,34
Empty boiler weight	kg	66,1	68	70,2
Power supply connection	V/Hz	230/50	230/50	230/50
Nominal power input	A	0,68	0,7	0,87
Installed electric power	W	135	140	165
Pump consumption	W	85	90	99
Fan consumption	W	33	37	48
Appliance electric insulation rating	-	IPX5D	IPX5D	IPX5D
NO _x class	-	3	3	3
Weighted NO _x	mg/kWh	139	130	146
Weighted CO	mg/kWh	101	106	100
Type of appliance	C12 / C32 / C42 / C52 / C82 / B22 / B32			
Category	II2H3+			

- Fume temperature values refer to an air inlet temperature of 15°C.
- The data relevant to domestic hot water performance refer to a dynamic inlet pressure of 2 bar and an inlet temperature of 15°C; the values are measured directly at the boiler outlet considering that to obtain the data declared mixing with cold water is necessary.
- * Specific capacity "D": domestic hot water flow rate corresponding to an average increase of 30K, which the boiler can supply in two successive withdrawals.

INSTALLER

USER

MAINTENANCE TECHNICIAN

3.19 COMBUSTION PARAMETERS.

		G20	G30	G31
Zeus Superior 24 kW				
Gas nozzle diameter	mm	1,35	0,79	0,79
Supply pressure	mbar (mm H ₂ O)	20 (204)	29 (296)	37 (377)
Flue flow rate at nominal heat output	kg/h	50	49	51
Flue flow rate at minimum heat output	kg/h	50	48	49
CO ₂ at Q. Nom./Min.	%	7,50 / 2,90	8,70 / 3,50	8,30 / 3,40
CO at 0% of O ₂ at Q. Nom./Min.	ppm	73 / 93	88 / 116	62 / 113
NO _x at 0% of O ₂ at Q. Nom./Min.	ppm	138 / 75	186 / 83	181 / 87
Flue temperature at nominal heat output	°C	115	118	114
Flue temperature at minimum heat output	°C	98	102	100
Zeus Superior 28 kW				
Gas nozzle diameter	mm	1,35	0,79	0,79
Supply pressure	mbar (mm H ₂ O)	20 (204)	29 (296)	37 (377)
Flue flow rate at nominal heat output	kg/h	58	55	57
Flue flow rate at minimum heat output	kg/h	61	59	60
CO ₂ at Q. Nom./Min.	%	7,50 / 2,94	9,10 / 3,55	8,70 / 3,46
CO at 0% of O ₂ at Q. Nom./Min.	ppm	97 / 104	179 / 103	90 / 99
NO _x at 0% of O ₂ at Q. Nom./Min.	ppm	123 / 77	184 / 89	168 / 88
Flue temperature at nominal heat output	°C	108	115	111
Flue temperature at minimum heat output	°C	79	82	81
Zeus Superior 32 kW				
Gas nozzle diameter	mm	1,35	0,79	0,79
Supply pressure	mbar (mm H ₂ O)	20 (204)	29 (296)	37 (377)
Flue flow rate at nominal heat output	kg/h	66	66	68
Flue flow rate at minimum heat output	kg/h	66	66	69
CO ₂ at Q. Nom./Min.	%	7,40 / 2,90	8,50 / 3,40	8,20 / 3,20
CO at 0% of O ₂ at Q. Nom./Min.	ppm	58 / 89	50 / 25	30 / 20
NO _x at 0% of O ₂ at Q. Nom./Min.	ppm	119 / 65	153 / 84	167 / 137
Flue temperature at nominal heat output	°C	119	121	118
Flue temperature at minimum heat output	°C	95	96	92